

8/17/99

5/9/2025
R:\Hydraulic\EC\POLK29_EC_EC8_Detour.dgn
9:45:15 PM

BRIDGE DESCRIPTION #29
CONCRETE DECK / BST SURFACE
METAL GUARDRAILS
2 CONCRETE BEAMS PERPENDICULAR W/ BRIDGE
DB 364 PG 1124
WOOD HEADWALLS
WOOD WINDWALLS
CONCRETE WHEELGUARD

PROJECT REFERENCE NO.	SHEET NO.
BPI4-R04I	EC-8/CONST.-2A
Weston & Sampson WSE of North Carolina, PC 2052 Energy Drive Phone: 919.297.0220	
NC License: C-4847 Apex, NC 27502 westonandsampson.com	

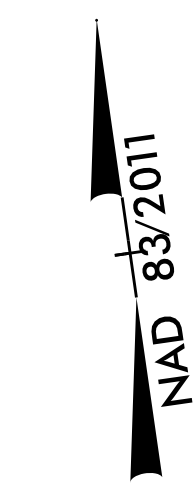

DETOUR

POLK COUNTY BOARD OF EDUCATION
DB 114 PG 8
DB 214 PG 1659
PLAT BOOK 4 - PG. 63
MAP CARD FILE B - PG. 771

JACKSON N. WALKER ESTATE
DB 101 PG 265
DB 106 PG 188
DB 159 PG 553

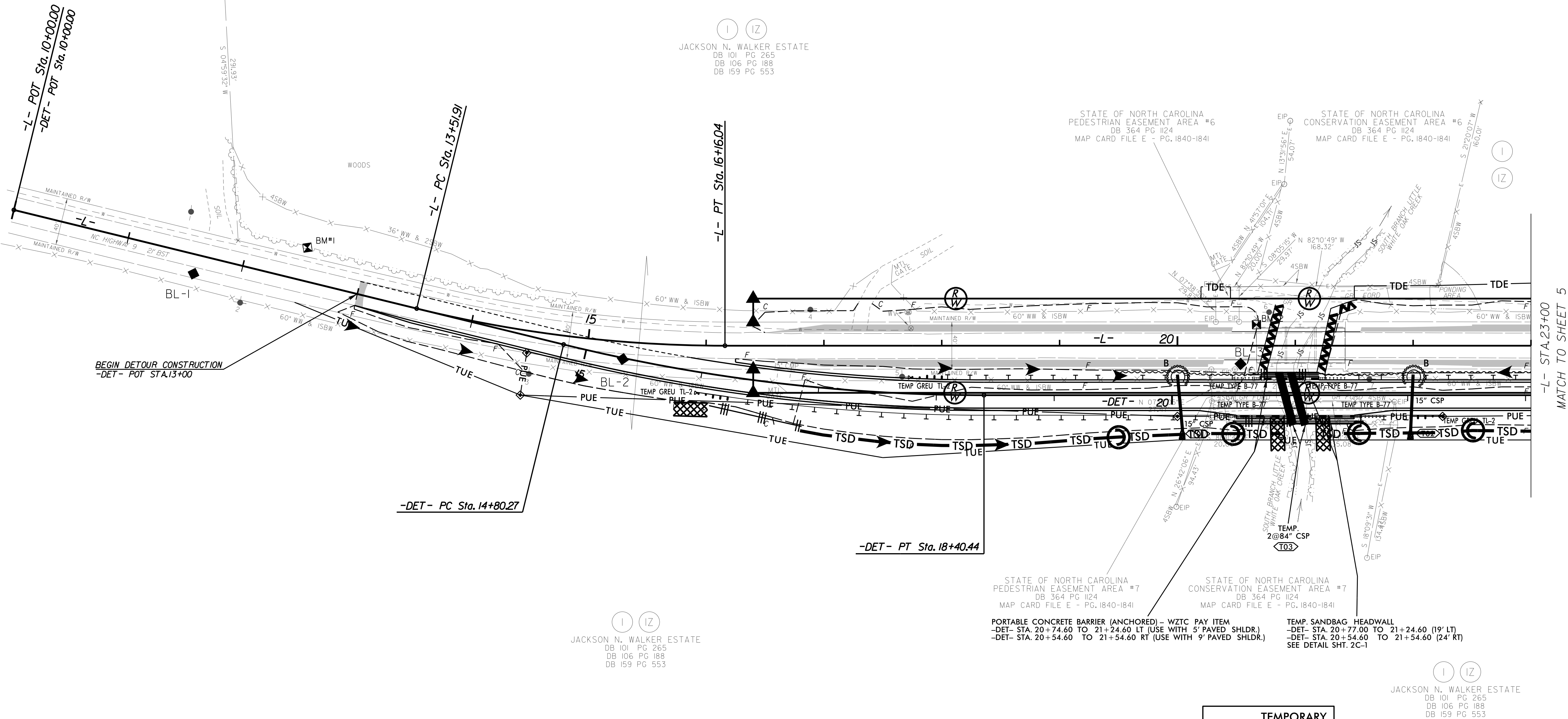

NOTE:
PLACE TEMPORARY ROCK SEDIMENT DAMS TYPE - B
AND TEMPORARY ROCK SILT CHECKS TYPE - A AT
DRAINAGE OUTLETS.

NOTE:
UTILIZE SPECIAL STILLING BASIN(S) AS STILLING BASIN
WHERE APPLICABLE

TEMPORARY
SHORING

FOR -DET- PROFILE, SEE SHEET NO. 2B-3

DETOUR SHEET (1 OF 2)